



Cast Ductile Iron Water Valve GGG40 GGG50 Tilting Disc Check Valve With Hammer Weight

Our Product Introduction

Basic Information

- Place of Origin: CHINA
- Brand Name: DEYE
- Certification: ISO9001:2015 PED
- Model Number: DY-CV-H-001-1
- Minimum Order Quantity: 10PCS
- Price: USD2-USD20000 each
- Packaging Details: carton box+ ply wooden cases or carton+ Pallets
- Delivery Time: 20 days for usual order, 7 days for stocked items
- Payment Terms: T/T, L/C, D/P
- Supply Ability: 1000pcs one month



Product Specification

- Highlight: Cast Ductile Iron Water Valve, Water Valve GGG40, GGG50 tilting disc check valve



More Images



for more products please visit us on piping-industry.com

Product Description

Model No. CV-H-001-1

ductile iron Tilting check valves with cylinder hydraulic DAMPER, PN16 . Temperature: -20 ~+120

Quick Detail

Design standard: BS /DIN standard

Pressure: PN16 PN25

End connection: RF. Flange

Face to face: EN558 Series 14

Test and inspection: API 598.

Connection: Flange ends conform to ASME B16.5 EN1092-1

Epoxy powder coated inside and outside 250Microns

FBE surface 250Microns.

Product Range:

Available Body Material: Cast Iron GG25, Ductile iron GGG40, GGG50

Available Disc Material: Ductile iron, Bronze

Optional Seat Ring: Brass, Bronze, SS304, SS316, EPDM

Optional Design: DIN /BS/ ANSI with difference Face to face length

Optional Ends: BS4504/EN1092-1 PN16/ ANSI B16.5 RF

Size Range: DN100-DN1200 4"-48"

Pressure Range: PN10, PN16, PN20(150LBS)

Optional surface color: RAL5002, RAL5015. RAL5005, red, black. Or customized

Performance:

- Tilting Check Valve, while allowing the flow moving to the desired flow direction, stops the flow when exposed to back flow
 - With the start of movement at defined flow direction on the system, the disc leaves the flow section by turning in its axis and allows the flow pass.
 - When the flow stops, the disc sits on the machined sealing seat through by force of extra weight and maintains 100% tight sealing.
 - The body and the disc can be manufactured as cast iron and ductile iron and sealing seats are manufactured from stainless steel
 - Hydraulic brake system can be assembled to disc closer unit if it is required at project.
- The rate of closure can be controlled due to tilting check valve with hydraulic brake system and the system passes to . static position slightly. The installation equipment protected from impact strength.

Construction of Tilting Disc Check valve

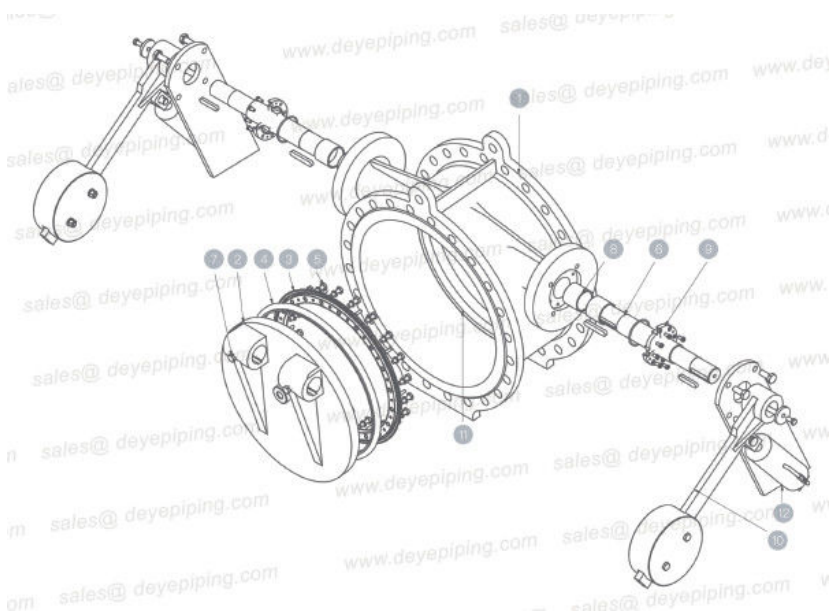

No.	Item Description	Material		Standard
		Standard	Optional	
1	Valve Body	Ductile Iron EN GJS 500/7	Ductile iron EN GJS 400/12	EN1563
2	Valve Disc	Ductile Iron EN GJS 500/7	Ductile Iron EN-GJS 400/12	EN1563

3-1	Retaining Ring (B)	Ductile Iron EN-GJS 600/7	Ductile Iron EN GJS 400/12	EN1563
3-2	Retaining Ring (A)	ss304	ss316	EN10099
4	Disc Seal	EPDM	NBR	
5	Retainer Bolts	S3304	S9316	EN10088
6	Shaft	X20Cr13{AEI 420J	89316	EN10088
7	Hex Bolt Nut	S3304	SS316	EN10088
8	Bearing	Self lubricating PTFE/Stoe		
9	Gland	Ductile Iron EN GJS 500/7	Ductile Iron EN GJS 400/12	EN1563
10	Counter weight & arm	Ductile Iron EN GJS 500/7	Ductile Iron EN GJS 400/12	EN1563
11	Body seat	93316	htcgrated in valvb body	EN10098
12	Hydraulic Damper	Carbon Stool		



Seal Construction

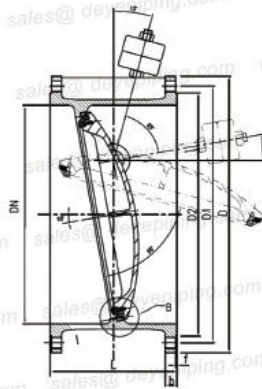
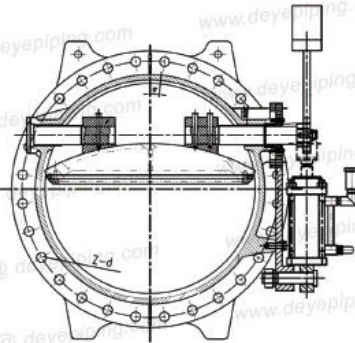

Design features

Nomina Diameter	F to F		PN10					PN16					PN25				
DN	L	f	ØD	ØD1	ØD2	b	Økn	ØD	ØK	Ød	b	Økn	ØD	ØK	Ød	b	Økn
100	190	3	220	180	156	19	19x8	220	180	156	19	19x8	235	190	156	19	23x8
125	200	3	250	210	184	19	19x8	250	210	184	19	19x8	270	220	184	19	28x8
150	210	3	285	240	211	19	23x8	285	240	211	19	23x8	300	250	211	20	28x8
200	230	3	340	295	266	20	23x8	340	295	266	20	23x12	380	310	274	22	28x12
250	250	3	405	350	319	22	23x12	405	355	319	22	28x12	425	370	330	24.5	28x16
300	270	4	460	400	370	24.5	23x12	460	410	370	24.5	28x12	485	430	389	27.5	31x16
350	290	4	505	460	429	24.5	23x16	520	470	429	26.5	28x16	555	490	448	30	34x16
400	310	4	565	515	480	24.5	28x16	580	525	480	28	31x16	620	550	503	32	37x16
450	330	4	615	565	530	25.5	28x20	640	585	548	30	31x20	670	600	548	34.5	37x20
500	350	4	670	620	582	28.5	28x20	715	650	609	31.5	34x20	730	660	609	36.5	37x20
600	390	5	780	725	682	30	31x20	840	770	720	36	37x20	845	770	720	42	41x20
700	430	5	895	840	794	32.5	31x24	910	840	794	39.5	37x24	960	875	820	46.5	44x24
800	470	5	1015	950	901	35	34x24	1025	950	901	43	41x24	1085	990	928	51	50x24
900	510	5	1115	1050	1001	37.5	34x28	1125	1050	1001	46.5	41x28	1165	1090	1028	55.5	50x28
1000	550	5	1230	1160	1112	40	37x28	1255	1170	1112	50	44x28	1320	1210	1140	60	57x28
1100	590	5	1355	1270	1218	53.5	37x32	1355	1270	1218	53.5	44x32	1420	1310	1240	64.5	57x32
1200	630	5	1455	1380	1328	45	41x32	1485	1390	1328	57	50x32	1530	1420	1350	69	57x32
1300	670	5	1585	1490	1432	59	42x32	1585	1490	1432	59	50x32	-	-	-	-	-
1400	710	5	1675	1590	1530	46	44x36	1685	1590	1530	60	50x36	1755	1640	1560	74	62x36
1500	750	5	1820	1700	1640	47	44x36	1820	1710	1640	62.5	57x36	1865	1750	1678	77.5	62x36
1600	790	5	1915	1820	1750	49	50x40	1930	1820	1750	65	57x40	1975	1860	1790	81	62x40
1800	870	5	2115	2020	1950	52	50x44	2130	2020	1950	70	57x44	2195	2070	1985	88	70x44
2000	950	5	2325	2230	2150	55	50x48	2345	2230	2150	75	62x48	2425	2300	2210	95	70x48



sales@deyepiping.com | www.deyepiping.com

Application:
water, steam, oil, pumping system



+8613292824811



sales@deyepiping.com



piping-industry.com

No. 368 Youyi St. Shijiazhuang, Hebei, China